

Modernlife Wall Hung Bidet Installation and User Guide

MODEL NUMBERS

MF0002KE-00

Important :- Please quote the above model number(s) when ordering spares.

IMPORTANT!

Installer: This manual is the property of the customer and must be retained with the product for maintenance and operational purposes.

CONTENTS

DESCRIPTION	3
SAFETY : WARNINGS	3
DIMENSIONS	3
SPECIFICATION	4
Plumbing Connections.....	4
INSTALLATION	4
Before You Begin	4
Install the Bidet	4-5
Install the Plumbing	6
USER MAINTENANCE.....	6
Cleaning.....	6
SPARE PARTS.....	6
NOTES	7
CUSTOMER SERVICE	8
Guarantee of Quality.....	8
Commercial / Business Use.....	8
Not Covered by this Guarantee.....	8
To Contact Us	8

DESCRIPTION

- The Kohler Bidet is designed for connection to a hot and cold water supply.
- This installation and user guide covers the Modernlife wall mounted vitreous china bidet.

SAFETY: WARNINGS

Kohler products are precision-engineered and should give continued superior and safe performance, provided:

1. They are installed, commissioned, operated and maintained in accordance with the recommendations given in this Manual.
2. Periodic attention is given, as necessary, to maintain the product in good functional order. Recommended guidelines are given in the **MAINTENANCE** section.

Carefully inspect the new fixture for any signs of damage.

When installing Kohler Products, manufacturers guidelines for power tool safety should be followed.

DIMENSIONS

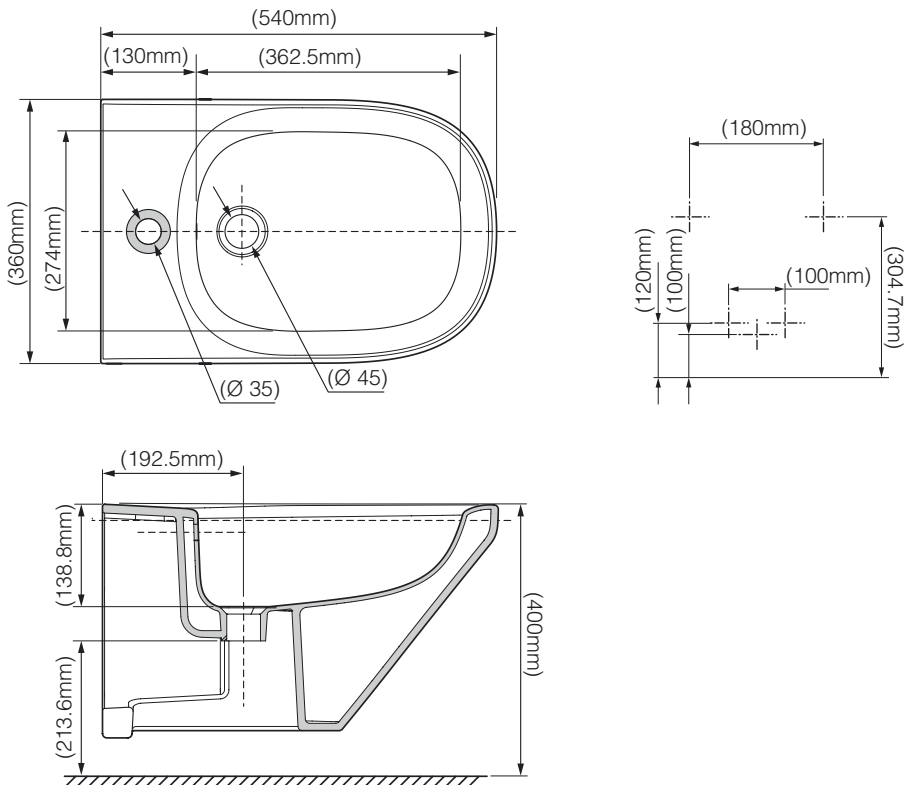

SPECIFICATION

Plumbing Connections

Hot (H) and Cold (C) inlets must be connected to the correct inlet supplies.

INSTALLATION

Before You Begin

1. Turn off the water supply.
2. The plumbing installation must comply with Water Supply Regulations/Bye laws (Scotland), Building Regulations or any particular regulations and practices, specified by the local water company or water undertakers. The installation should be carried out by plumber or contractor who is registered with, or is a member of an association such as:

Institute of Plumbing (IOP), throughout the UK.

National Association of Plumbing, Heating and Mechanical Services Contractors (NAPH & MSC), England and Wales.

Scottish and Northern Ireland Plumbing Employers' Federation (SNIPEF), Scotland and Northern Ireland.

3. Before installation carefully inspect the new fixture for any signs of damage.

Install the Bidet

1. Install the services.
2. Make sure that the hot and cold water supply pipes and the waste are installed correctly.

Note! The hot and cold water supplies must be installed with isolating valves.

3. Fit the taps to the bidet in accordance with the manufacturer's instructions.
4. Refer to dimensions and mark the centre holes on the wall for the attachment bolts.

Caution! Make sure that you avoid hidden cables and pipes when drilling holes in the wall.

5. Drill the fixing holes using an 8mm dia drill.
6. Insert the wall plugs into the drilled holes and fit the attachment bolts.

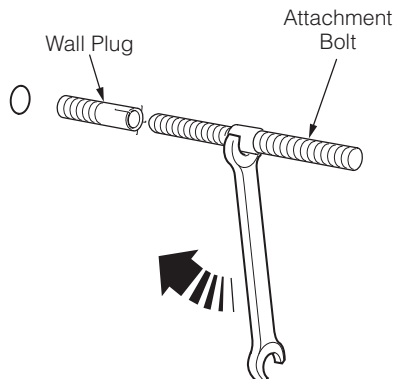

7. Screw the metal sleeves, supplied in the component pack, on to the attachment bolts (ensuring groove facing downwards).

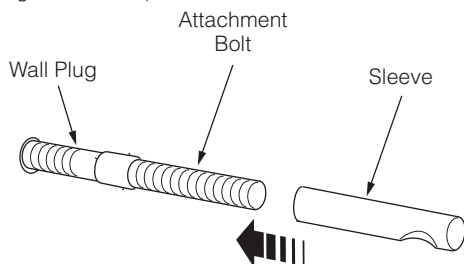

8. Insert the Fixation kit, supplied in the component pack, into the bidet ensuring that they are fully pushed in and the grub screws are facing downwards.

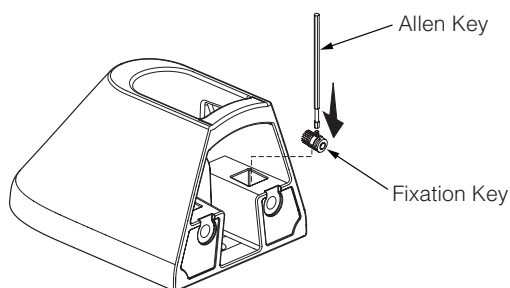

9. Apply silicone sealant or a sand and cement mixture to the back of the bidet.

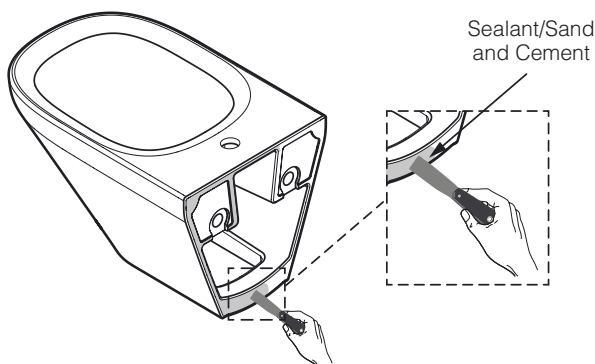

10. Loosen the grub screws with the tool provided in the component pack and position the bidet on the wall.
11. Tighten the grub screws.

Install the Plumbing

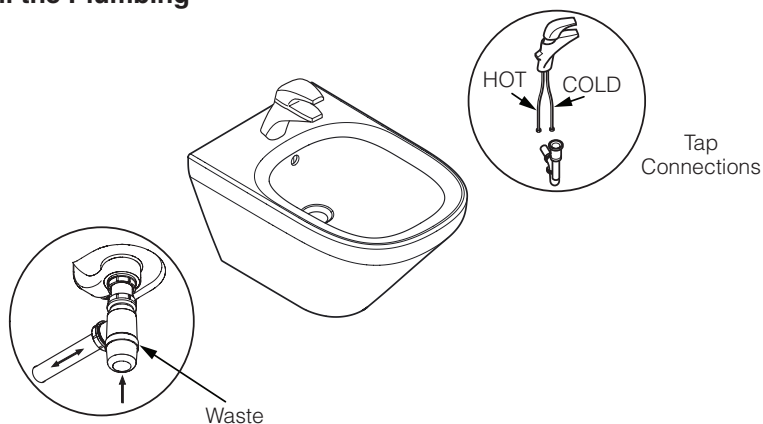

1. Install the drain in accordance with the manufacturer's instructions.
2. Connect the taps to the water supply.
3. Open the hot and cold water valves, and check the supply connections for leaks.
4. Run water into the bidet, and check the drain connections for leaks.

USER MAINTENANCE

Cleaning

Caution! Risk of product damage. Many cleaners contain abrasive and chemical substances, and should not be used for cleaning stainless steel, enamel, plated or plastic fittings. These finishes should be cleaned using a mild washing up detergent or soap solution, rinsed and then wiped dry with a soft clean cloth.

Caution! Risk of product damage. Most toilet bowl cleaners are not harmful to the vitreous china surface of the toilet bowl. Please follow the bowl cleaner manufacturer's instructions carefully.

Warning! Do not use in-tank cleaners. Products containing chlorine (calcium hypochlorite) can seriously damage fittings in the tank. This damage can cause leakage and property damage.

SPARE PARTS

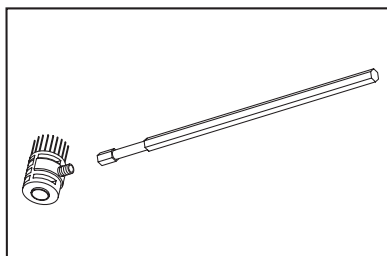

(RTA097NF)
Wall Installation Kit

NOTES

CUSTOMER SERVICE

Kohler UK guarantee products against any defect of materials or workmanship for the following periods.

25 Years

Ceramic ware and cast products

10 Years

Stainless steel products, Acrylic baths and shower trays

5 Years

Shower valves, shower enclosures, taps, cistern fittings, toilet seats, bath panels, bathroom furniture and accessories

2 Years

Bathroom Furniture

1 Years

Whirlpool / Spa baths

Our confidence in the quality and reliability of our superior products enables us to offer a comprehensive guarantee for all products.

To register and fully benefit from this guarantee you must return the enclosed product registration card indicating the Kohler items you have purchased.

Within the guarantee period we will undertake to resolve any material defects, by providing replacement parts, modules or complete product, as we deem appropriate. To be free of charge, work must only be undertaken by Kohler UK approved personnel.

To ensure that any problems can be promptly resolved you must contact Kohler UK directly.
Proof of purchase must be provided with any claims.

This guarantee covers products in domestic use, installed, operated and maintained in accordance with the instructions. It covers the purchaser only and is not transferable.

Commercial / Business Use

Any Kohler Bathroom product used within a commercial / business premise is guaranteed for 1 Year against any defect of materials or workmanship.

Not Covered by this Guarantee

Damage or defects arising from incorrect installation, improper use or lack of maintenance.
Installed product damaged in transit
Consequential loss, damage or product removal and installation costs.
General wear and tear.

This guarantee is in addition to your statutory and other legal rights.
Applies to the UK only.

To Contact Us

Tel: 0800 001466

email: info@kohler.co.uk

Website: www.kohler.co.uk

Kohler Mira Ltd
Cromwell Road,
Cheltenham GL52 5EP.

The company reserves the right
to alter product specifications
without notice.

KOHLER®