



ESCALE 艾思格尔  
INSTALLATION INSTRUCTIONS  
安装说明书  
FLOOR STANDING TOILET  
釉面陶瓷落地座便器  
K-95027K-S

## BEFORE YOU BEGIN

- Please read these instructions carefully to familiarize yourself with the required tools, materials, and installation sequences. Follow the sections that pertain to your particular installation. This will help you avoid costly mistakes. In addition to proper installation, read all operating and safety instructions.
- All information in these instructions is based upon the latest product information available at the time of publication. Kohler China reserves the right to make changes in product characteristics, packaging, or availability at any time without notice.
- These instructions contain important care, cleaning, and warranty information - **please leave instructions for the consumer.**
- Fixture dimensions are nominal and conform to tolerances established by ASME Standards (A112.19.2-2013).
- The product complies with GB 6952-2015.

## 安装之前

- 请小心详阅本指引。以便熟悉所需工具、材料及安装程序。请遵照适用的章节来安装你的座便器，以避免由于安装不当而导致不必要的损失。除了有关正确的安装方法之外，还务请详阅所有操作及安全指引。
- 本指引所载之一切资料，均以印刷时所有之最新产品情况为基础，科勒中国保留权利随时更改产品特性、包装或供应情况，恕不另行通知。
- 本指引也包含了有关护理、清洁及保养等重要资料 - 请交予用户保存。
- 部件尺寸为标定值，误差符合美国ASME标准(A112.19.2-2013)。
- 本产品符合GB 6952-2015。

## ORDERING INFORMATION

Escale Floor Standing Toilet.....K-95027K-S  
Includes Bowl.....K-4097K  
Includes ESCALE Quick-Release QC Seat..K-4417T-2PM

## 订购信息

艾思格尔釉面陶瓷落地座便器.....K-95027K-S  
含缸体.....K-4097K  
含艾思格尔快拆缓降盖板.....K-4417T-2PM

## SAFETY: WARNINGS

Kohler products are precision-engineered and should give continued superior and safe performance, provided:

1. They are installed, commissioned, operated and maintained in accordance with the recommendations given in this Manual.
2. Periodic attention is given, as necessary, to maintain the product in good functional order. Recommended guidelines are given in the **MAINTENANCE** section.

Carefully inspect the new fixture for any signs of damage.

When installing Kohler Products, manufacturers guidelines for power tool safety should be followed.

## 安全：警告

科勒产品经过精确制造，性能卓越，经久耐用。为保证产品品质，您必须：

1. 按照此手册中推荐的方法进行安装、启动、操作及维护。
2. 如有需要，定期检查，令产品保持良好性能状态。日常维护章节中列有推荐方法。

仔细检查新产品是否有损伤。

在安装科勒产品时，必须遵循制造商有关电气安全的指令。

No.2 KOHLER ROAD, SANSHUI CENTRAL INDUSTRIAL PARK, LEPING TOWN, SANSHUI DIST., FOSHAN, GUANGDONG, PRC POST CODE 528137  
广东省佛山市三水区乐平镇三水中心工业园区科勒大道2号 邮编：528137

8# MENGSHAN RD, ECONOMIC DEVELOPMENT ZONE OF HUANTAI, ZIBO, SHANDONG, CHINA POST CODE: 256410  
山东省淄博市桓台经济开发区蒙山路8号 邮编：256410

## RECOMMENDED TOOLS AND MATERIALS (Not Supplied)

## 推荐工具及材料(不随货供应)

- Safety Glasses
- Tape Measure
- Putty Knife
- Pipe Wrench
- Adjustable Wrench
- Tubing Cutter
- 1/2" Nut Driver or socket
- Pencil
- Waxseal
- Supply Shut-off Valve
- Level
- Screwdriver
- Sponge
- Sealant

- 护眼镜
- 卷尺
- 涂油灰刀
- 喉管板钳
- 活动板钳
- 切管刀
- 1/2"直径螺帽板头或套筒板手
- 铅笔
- 蜡封垫圈
- 止水阀
- 水平尺
- 螺丝刀
- 海绵
- 密封胶

## ROUGHING-IN

## 尺寸图

Reference Value  
参考值

UNIT: mm  
单位: 毫米

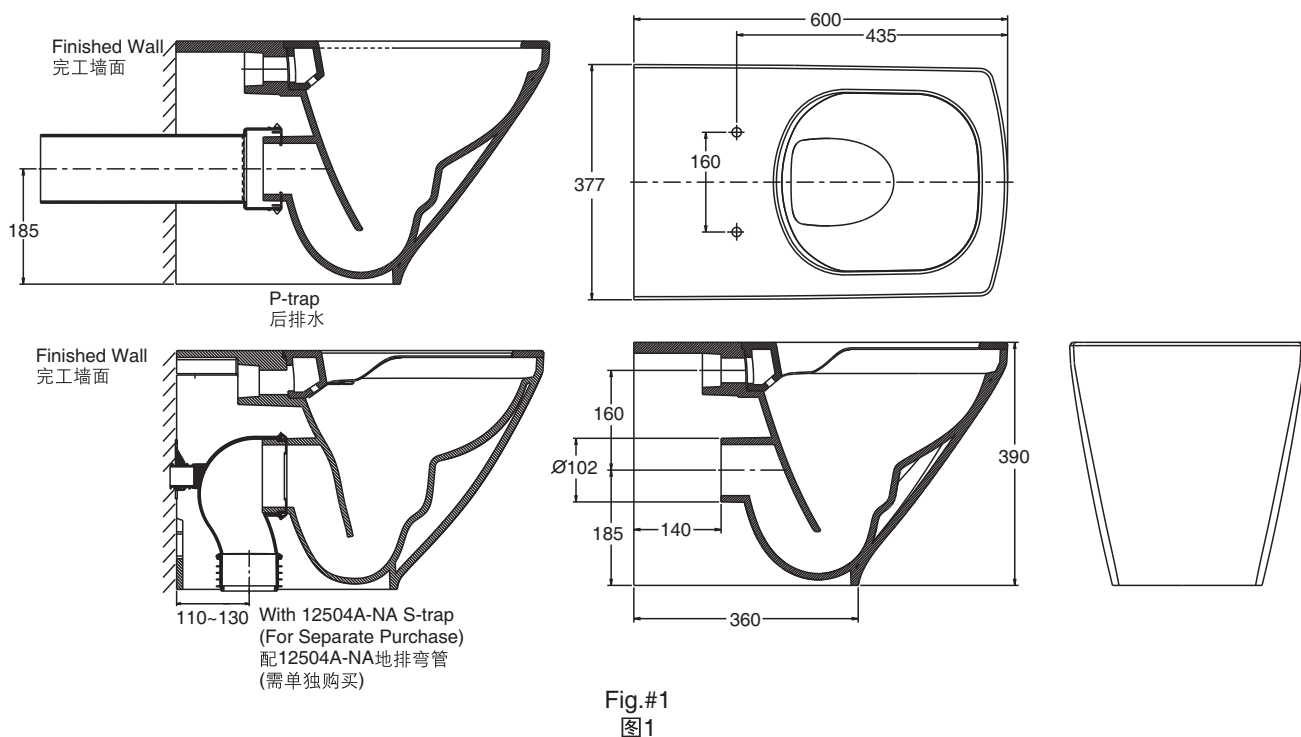

Kohler reserves the right to change marked dimensions without prior notice.  
科勒公司保留随时变更图中标示尺寸的权利，无需另行通知。

## SPECIFICATION

## 规格

### Plumbing Connections

### 管道连接

Recommended inlet connections are 3/8" BSP.

建议采用3/8" BSP进水管接口。

## INSTALLATION

## 安装

### Recommended tanks for 3/4.5L

In-wall Tank K-10611T-NA(w/o iron rank) And In-wall Tank plate K-4177T-CP and K-8857T-CP. (Need separate purchase for plate)

### 推荐使用的水箱3/4.5L

入墙式隐藏水箱K-10611T-NA(无固定支架), 面板需另配K-4177T-CP或K-8857T-CP。

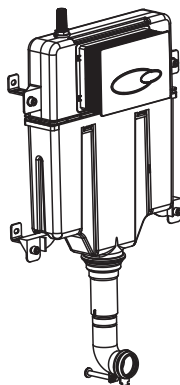

Fig.#2  
图2

### Install the Toilet

### 安装座便器

1. Install the waste outlet and water inlet as shown.

1. 在安装面上安装排污管及冷水进水管, 如图所示。

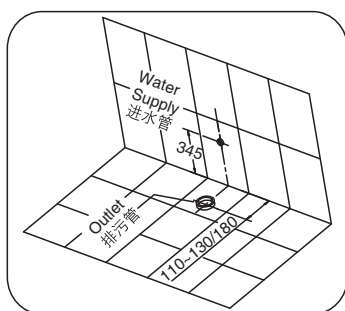

S.trap  
地排水

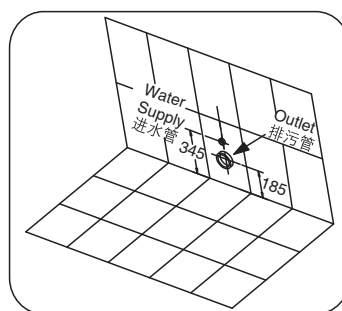

P.trap  
墙排水

UNIT: mm  
单位: 毫米

Fig.#3  
图3

2. Put the bowl in position, and using a pencil, mark the position of the bowl on the floor, as shown. Mark the positions for the tank attachment bolts on the wall.

2. 首先确定安装墙面或地面排污口的中心位置和座便器左右中心的位置, 并画线标识。将座便器放置到位, 使安装面排污口中心线和座便器左右中心线重合, 然后画线标识座便器位置。如图所示。

**Caution!** Make sure that you avoid hidden cables and pipes when drilling holes in the floor or wall.

**小心!** 在地面或墙面上钻孔时, 一定要避开内设的线缆和管道。

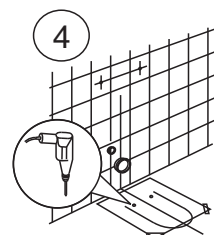
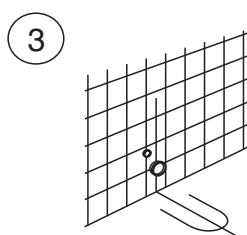
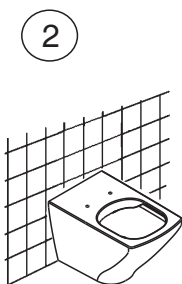
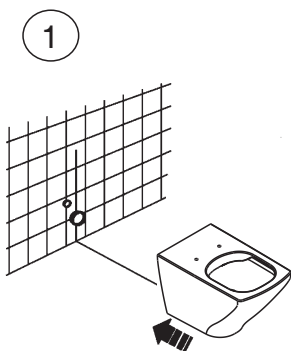

Fig.#4  
图4

3. Remove the bowl and place the installation template on the floor. Drill the anchor bolt hole (depth  $\geq 38\text{mm}$ ) in the floor with an 15mm dia. drill, then remove the template.

It is suggested to reverse the bowl before drilling with the template. Compare the actual loaction of installation hole with the template to map more accurate installation location, as shown in the following figure.

3. 移开座便器，将安装模板固定在地面上，确定地脚孔的位置，然后使用15毫米的钻头，钻深度不小于38毫米的地脚孔。

建议在利用安装模板钻孔前，先将座便器小心倒放，将安装模板与座便器的脚部安装孔的实际位置对比，以获得更符合的位置。如图

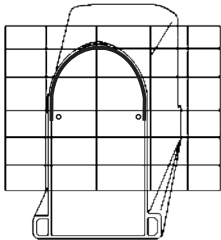

Fig.#5  
图5

4. Adjust the distance between centerline of PVC waste pipe and the floor (wall) to match it consistent with marked roughing-in.

4. 依照安装地面排污口离墙距，调节确定PVC排污管软接头与座便器排污口连接的前后位置，使两者距离相一致。如图所示。



UNIT: mm  
单位: 毫米

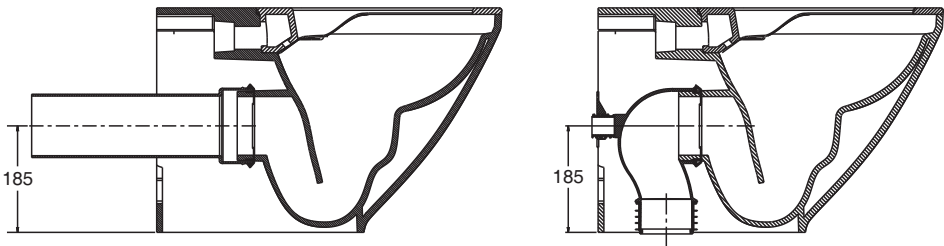
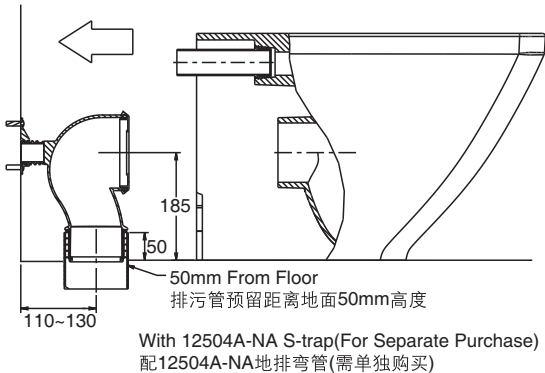

Fig.#6  
图6

Installation of S trap: Fix S trap onto wall with expansion screw and insert into the reserved drainage pipe(Fig.7). Push the bowl to insert the drainage hole into the S trap and also insert the water pipe into the outlet of the in-wall tank.

地排弯管安装：地排弯管需先用膨胀螺钉固定于墙面，排污口接入建筑预留的排污管道（见图7）；随后再平推陶瓷坐便器，使陶瓷排污口插入地排弯管入口、同时进水管插入入墙式水箱出水口。



With 12504A-NA S-trap(For Separate Purchase)  
配12504A-NA地排弯管(需单独购买)

Fig.#7  
图7

5. Move the toilet to the field and make sure the bottom profile matches marked line on the ground.

5. 将座便器抬放至安装位置，确保与地面的标识线相吻合。

6. Install the threaded rods through the seat holes in the bowl. Tighten bolts with hex wrench. Making sure that they install correctly in the holes in the floor.

6. 穿过座便器上的盖板安装孔插入长地脚螺栓杆。使用六方扳手将螺栓旋紧，从而固定座便器。

It is suggested to use other auxillary light such as torch to eluminate one preserved installation hole of the toilet. Watch the movement of the threaded rod through the other installation hole to better control the installation process.

**NOTE:** Do not use white cement or high lime content cements to install this toilet. The expansion of cement due to a rise in temperature may make the toilet crack or cause damage. Kohler is not responsible for any damage caused by installation with the use of cement.

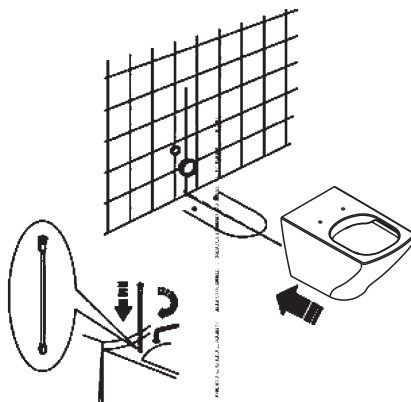

Fig.#7  
图7

建议另外用手电筒等辅助光源从座便器的预留孔内照入，安装人员从另一个孔中观察长地脚螺栓杆，从安装孔穿过并对准所钻地地面安装孔的情况，以提高安装的效率。

注意：安装本座便器时切勿使用白水泥或高石灰含量之水泥，因水泥的热膨胀可能使座便器的脚部挤破或损坏。科勒对所有因水泥安装而引致的座便器破裂恕不负责。

## USER MAINTENANCE

## 日常维护

### Cleaning

### 清洁

**Caution! Risk of product damage.** Many cleaners contain abrasive and chemical substances, and should not be used for cleaning stainless steel, enamel, plated or plastic fittings. These finishes should be cleaned using a mild washing up detergent or soap solution, rinsed and then wiped dry with a soft clean cloth.

**警告！小心产品受损。**许多清洁剂都含有腐蚀性及化学物质，不可用于清洁不锈钢、搪瓷、镀层或塑料制品。这些表面须使用温和的洗涤剂或皂液进行清洁，彻底冲洗，然后用干净的软布擦干。

**Caution! Risk of product damage.** Most toilet bowl cleaners are not harmful to the vitreous china surface of the toilet bowl. Please follow the bowl cleaner manufacturer's instructions carefully.

**警告！小心产品受损。**大多数座便器清洁剂不会损伤其釉面陶瓷表面。请仔细遵循清洁剂使用说明书进行操作。

**Caution! Do not use in-tank cleaners.** Products containing chlorine (calcium hypochlorite) can seriously damage fittings in the tank. This damage can cause leakage and property damage.

**警告！切勿使用水箱内置清洁剂。**含有氯（次氯酸钙）的清洁剂产品会严重损坏水箱内的装置。这将导致渗漏及财产损失。

**CAUTION: Don't use any cement while installing the toilet.** Heat expansion of the toilet may damage the feet of the toilet. Kohler will not be responsible for any damage because of using cement.

**警告：在安装本座便器时切勿使用任何水泥。**因为水泥的热膨胀可能使座便器的脚部挤破或损坏。科勒对所有因为水泥安装而引起的座便器破裂恕不负责。

**WARNING: Risk of product damage.** Do not throw into the toilet what is easy to block it, such as newspaper, paper pilch, sanitary towel. Do not bump the vitreous china with great force to prevent it from damaging and leaking. Do not use the product in the water below 0°C.

**警告：提防损坏产品。**请不要向便器内冲入新闻纸、纸尿裤、妇用卫生巾等容易堵塞的物品。请不要用重力撞击陶瓷，以防止破损漏水。

不要在0°C以下的水环境中使用。

**CAUTION:** Please do not use hard materials (like scouring pad) to clean product surface, especially the product logo.

**警告：**请勿使用钢丝球等硬质材料擦洗产品表面，特别是产品商标处。