

Slide Bar with Handspray

28016ME Slide bar, with Handspray

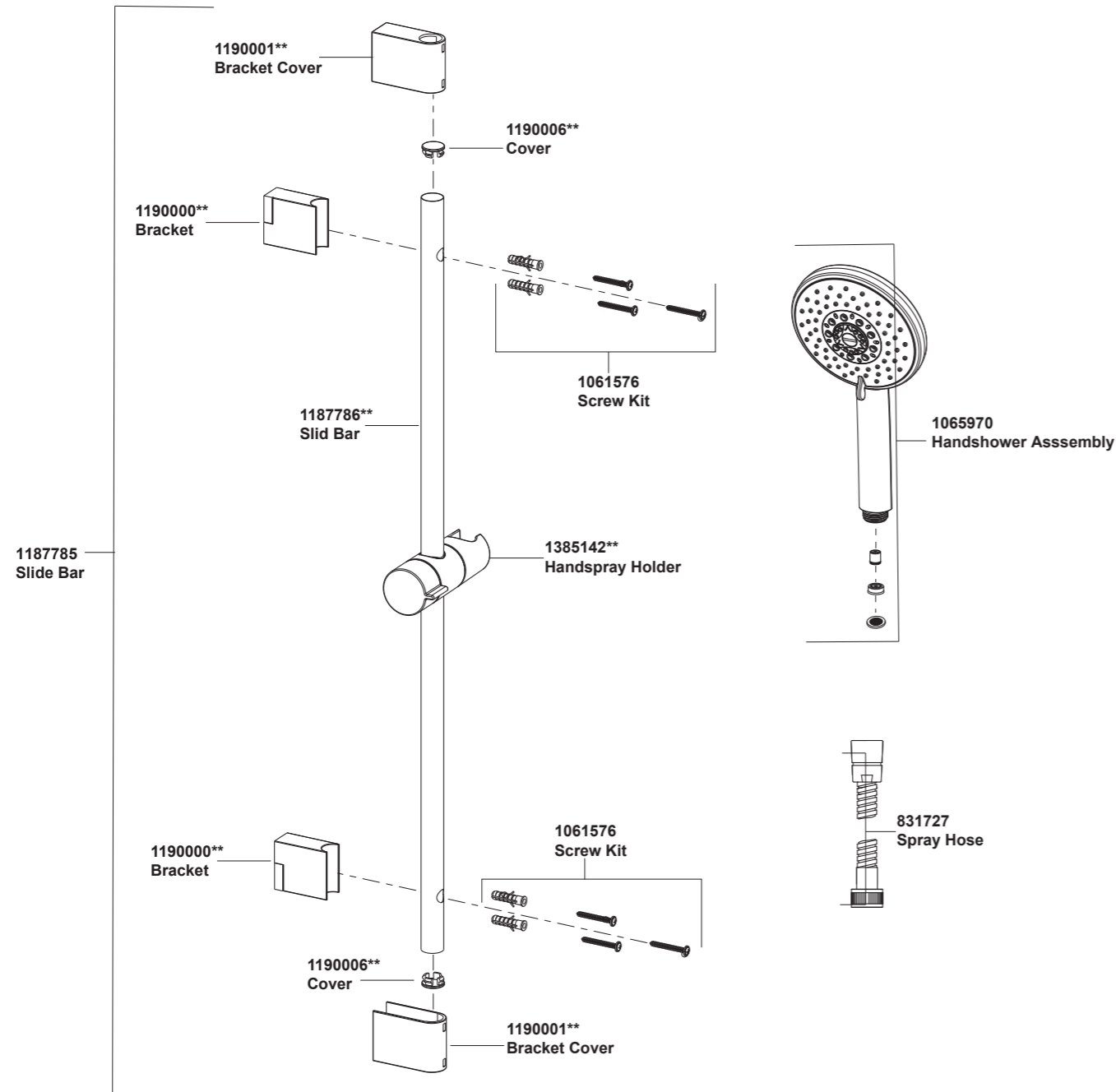

**Color code must be specified when ordering

ADDRESS:
Kohler Middle East Trading FZE
CONTACT.MIDDLEEAST@KOHLER.COM
WWW.ME.KOHLER.COM
+97143642650

INSTALLATION INSTRUCTIONS

Slide Bar with Handspray

28016ME Slide bar, with Handspray

BEFORE YOU BEGIN

All information is based on the latest product information available at the time of publication. Kohler Co. reserves the right to make changes in product characteristics, packaging, or availability at any time without notice. Please leave these instructions for the consumer. They contain important information.

NOTES:

1. Flush the water supply pipes thoroughly to remove debris.
2. Observe all local plumbing and building codes.
3. Shut off the main water supply.
4. The product must be installed in conjunction with a faucet (purchased separately).
5. The highest working pressure for showerhead & handspray is 0.5 Mpa (5 bar). If it exceeds 0.5Mpa (5 bar), a pressure reducer is needed. The highest water and environment temperature is 60°C. Please keep showerhead & handspray away from heater, or maybe damage it and hurt user.

ROUGH-IN DIMENSIONS

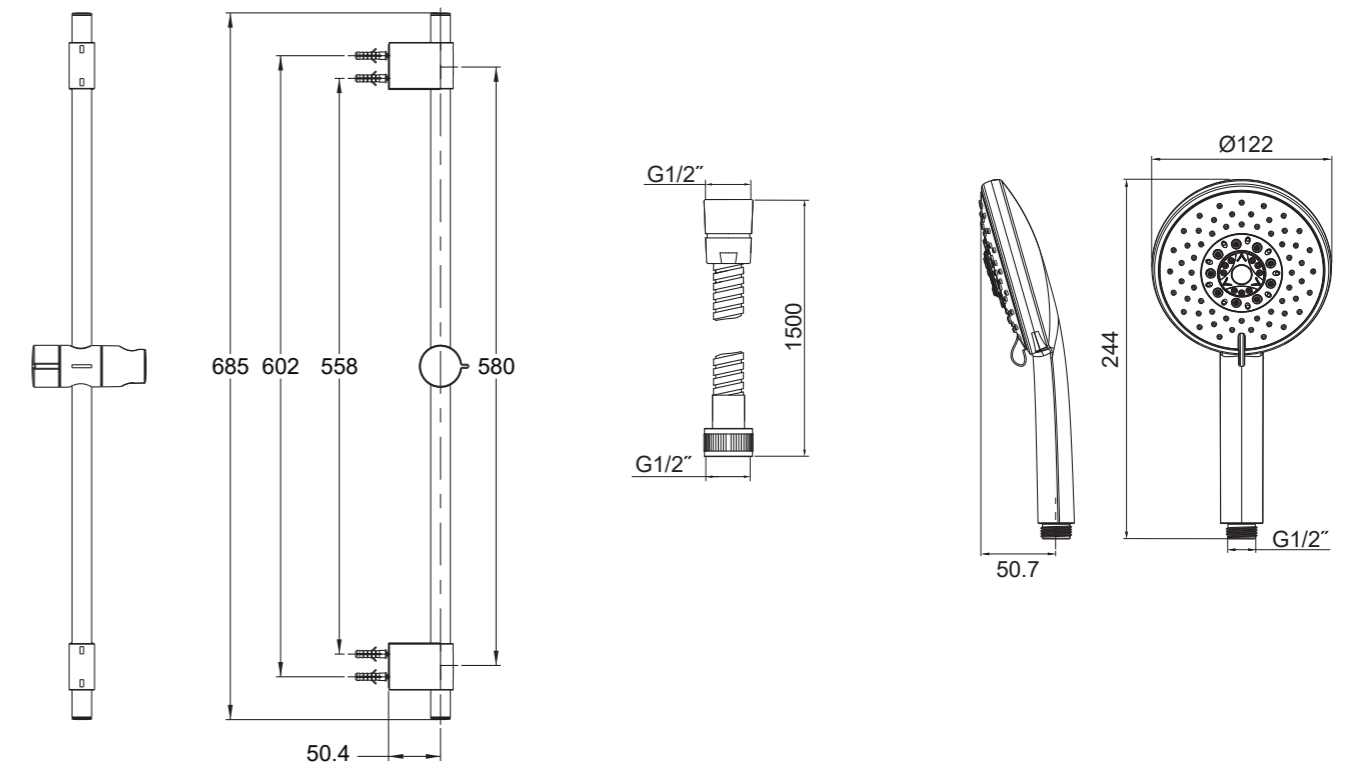

INSTALLATION

How to Install the Slide Bar

Decide on a suitable position for the slide bar avoiding buried cables and pipes in the wall.

Drill two holes at the proper height in the wall as the bracket(1,8) dimensions. Put anchors(2) into the holes. Install the bracket(1) with screws(3) in the wall.

Rehearse the slide bar(4), screws(5) and bracket(8). Mark the outline of the bracket with a pencil on the wall, and find the position of the holes. Drill two holes and put anchors(2) into the holes. Install the bracket(8) with screws(3) in the wall.

Slide the handspray holder(9) onto the bar(4). Adjust the holder to the proper position. Tighten the slide bar kit with screws(5).

Slide the bracket covers(6) onto the slide bar, and install the covers(7).

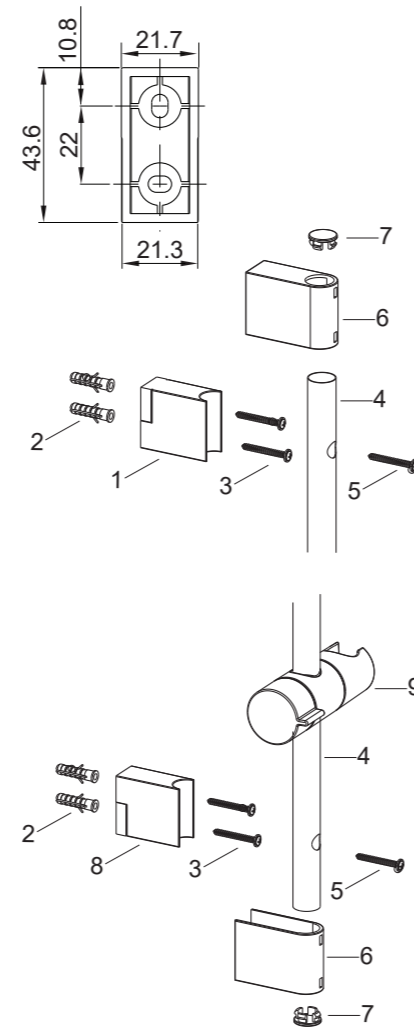

How to Install the Hose

Put the washer(1) into each connector of hose(2). Connect handspray and wall-mount supply elbow or shower outlet with hose.

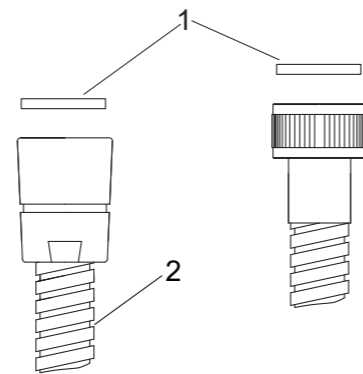

How to Install the handspray

Flush both water supply for about one minute before the handspray is installed.

Put the check valve(2) into the handspray(1) inlet.

Note: Keep the O-ring of the check valve downward.

Install flow regulator(3) into the shower inlet if needed.

Note: If working pressure is too low, regulator is not needed.

Put the screen washer(4) into the shower hose(5, not provided) connector. Attach the handspray to shower hose. **Note:** Don't over tighten.

Connect another end of shower hose to the water supply.

Note: If working pressure is higher than 3bar(0.3MPa), regulator should not be taken out, or the handspray will be damaged.

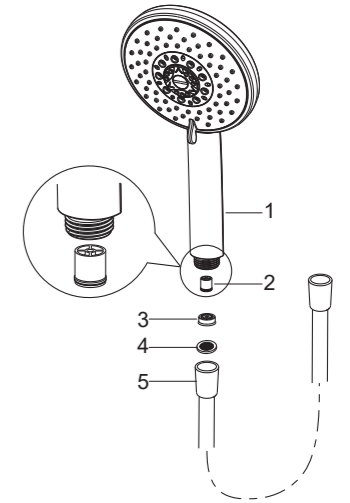

OPERATING INSTRUCTIONS

How to Clean the Nozzles

Any debris or mineral build-up may cause the flow stream to become distorted or reduce the flowrate. To remove the debris or mineral build-up, run water through the handspray, firmly press or rub your finger back and forth across the rubber nozzles.

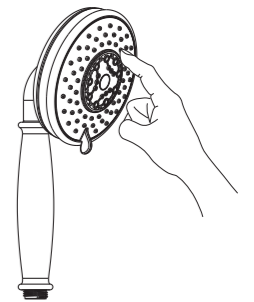

INSTALLATION CHECKOUT

Ensure that all coupling nuts are tightened. Turn on the main water supply, and check for leaks. Repair as needed.

CLEANING INSTRUCTIONS

All Finishes: Clean the finish with mild soap and warm water. Wipe entire surface completely dry with clean soft cloth. Many cleaners may contain chemicals, such as ammonia, chlorine, toilet cleaner etc. which could adversely affect the finish and are not recommended for cleaning.

Do not use abrasive cleaners or solvents on Kohler faucets and fittings.