

15344T-E2 Multi-Function Handspray
45973T-E2 Handshower-Traditional

BEFORE YOU BEGIN

All information is based on the latest product information available at the time of publication. Kohler Co. reserves the right to make changes in product characteristics, packaging, or availability at any time without notice.

Please leave these instructions for the consumer. They contain important information.

NOTES:

1. Flush the water supply pipes thoroughly to remove debris.
2. The highest working pressure for spray is 0.5MPa(5 bar). If it exceeds 0.5MPa(5 bar), a pressure reducer is needed. The highest water and environment temperature is 60°C. Please keep handspray, showerhead and the shower arm away from heater, or it may become damaged and cause injury to the user.

STANDARD APPLICABLE

Special model meets or exceeds the following at date of manufacture: TIS

ROUGH-IN DIMENSIONS

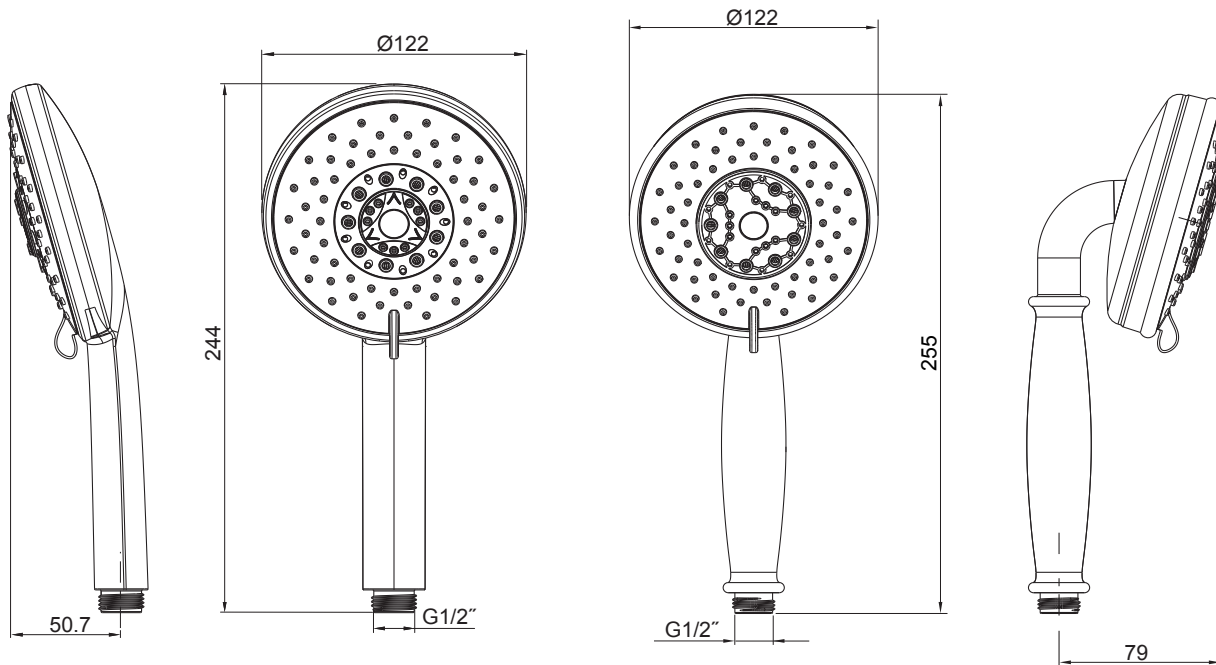

15344T-E2

45973T-E2

INSTALLATION

Flush both water supply for about one minute before the hand shower(1) is installed.

Install flow regulator(2) into the shower inlet if needed. **Note:** If working pressure is too low, regulator is not needed.

Put the screen washer(3) into the shower hose(4) connector. Attach the hand shower to shower hose. **Note:** Don't over tighten.

Connect another end of shower hose to the water supply.

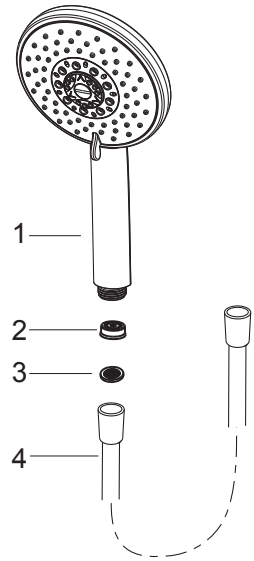

CLEANING INSTRUCTIONS

All Finishes: Clean the finish with mild soap and warm water. Wipe entire surface completely dry with clean soft cloth. Many cleaners may contain chemicals, such as ammonia, chlorine, toilet cleaner etc. which could adversely affect the finish and are not recommended for cleaning.

Do not use abrasive cleaners or solvents on Kohler faucets and fittings.

SERVICE PARTS

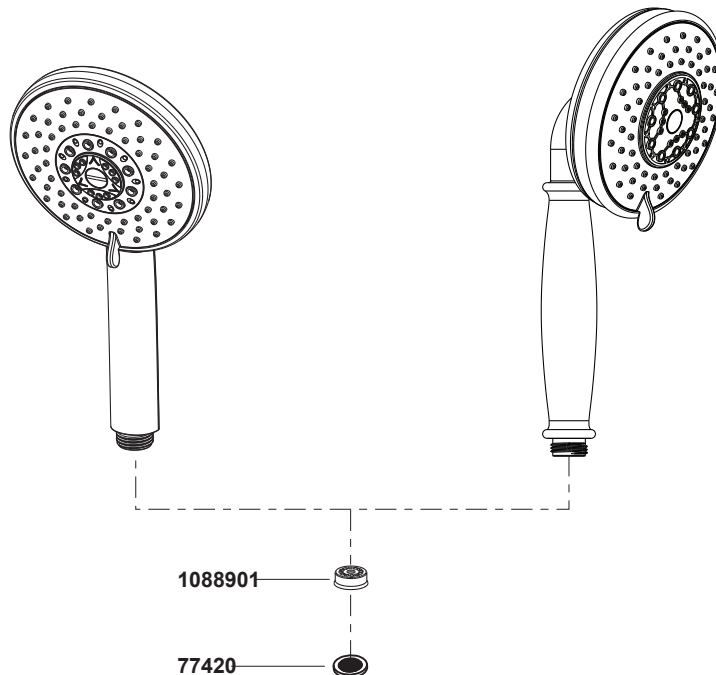

**Color code must be specified when ordering