

BEFORE YOU BEGIN



WARNING:

Risk of personal injury or product damage. Handle with care.

Vitreous China can break or chip if the bolts and nuts are over-tightened, or if the product is handled carelessly.

- Observe all local plumbing and building codes.
- Carefully inspect the new toilet for any damage. In case of any damage, please discard the product & contact Kohler customer care.
- If the In-wall tank is not installed, refer to the manufacturer's instructions before installation.

ORDERING INFORMATION

SPAN® Square/Round Wall-Hung Toilet.....K-29174IN-S-*/K-29171IN-S-*

Includes SPAN® Square/Round Wall-Hung Toilet Bowl.....K-29172IN-*/K-29169IN-*

Includes SPAN® Square/Round Quiet-close™ Toilet Seat...K-29173IN-*/K-29170IN-*

* Finish/color code to be specified while ordering.

RECOMMENDED TOOLS AND MATERIALS

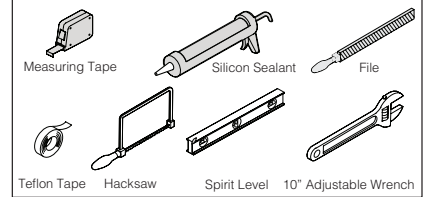

RECOMMENDED TANKS

Description	In-wall Tank	Cover/Faceplate
Instaflush In-Wall Tank	K-77027IN-M/P-NA , K-P77027IN-M/P-NA	K-4177IN-M-*, K-8857IN-M-*, K-75890IN-M/P-*, K-75891IN-M-*, K-5413IN-M/P-*

Product is compliant to flush performance tests as per ASME A112.19.2 at given flush volumes only when tested as per Kohler In-wall tanks mentioned in section above "RECOMMENDED TANKS".

ROUGHING-IN

P-Trap
Unit: Inches (cm)

29172IN-*

29169IN-*

NOTES:

- Fixture dimensions are nominal and conform to tolerances as per ASME Standard A112.19.2M.
- Product illustrations shown are representative only; actual product may vary.
- Kohler reserves the right to make changes in product characteristics, packaging or availability at any time without notice.

CAUTION : Do not use white cement or high lime-content cement to install this toilet. The expansion of cement due to rise in temperature may cause the toilet to crack or be damaged. Kohler is not responsible for any damage due to installation with the use of cement.

** - indicates WC mounting dimension

INSTALLATION INSTRUCTIONS

1. Cut bolts if needed. File bolt ends.

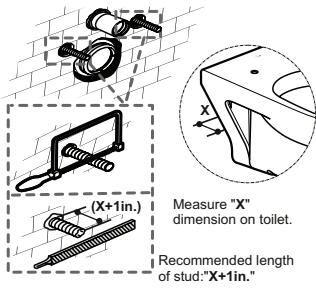

2. Remove Inlet Plug and Drain Plug.

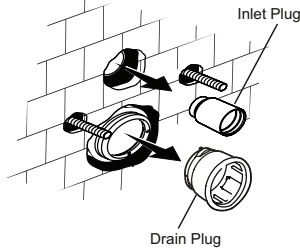

3. Slide the gaskets on the Inlet & Outlet pipe as shown.

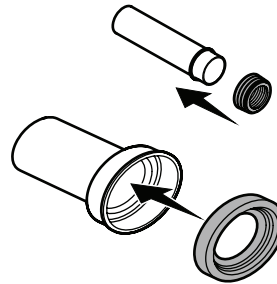

4. Slide the inlet pipe into wall openings for water inlet. Test fit the toilet.

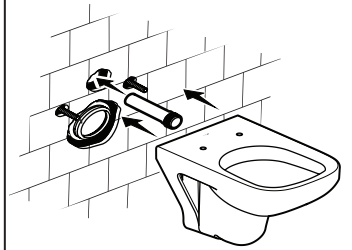

5. Note the distance between the wall & the toilet at the location shown. Measure excess length "A" on the inlet pipe.

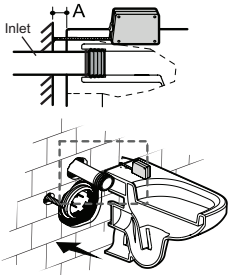

6. Remove the toilet. Cut & file the inlet pipe to proper length by removing excess length "A".

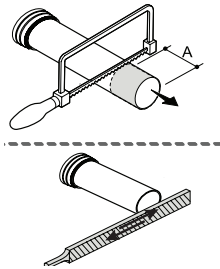

7. Slide the outlet pipe into the wall openings at waste outlet to test the fitment of outlet pipe with toilet.

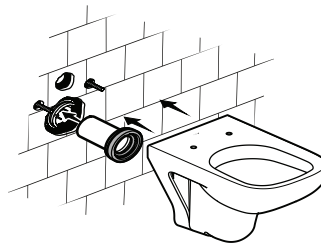

8. Note the distance between the wall & the toilet at the location shown. Measure excess length "B" of the outlet pipe.

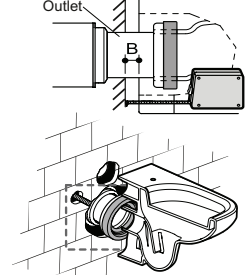

9. Remove the toilet. Cut & file the outlet pipe to proper length by removing excess length "B".

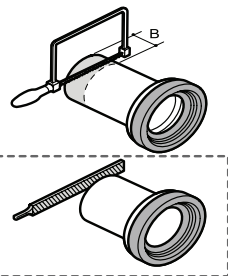

10. Add silicon sealant in the gasket grooves.

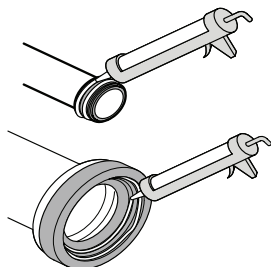

11. Mount the toilet on the projected studs.

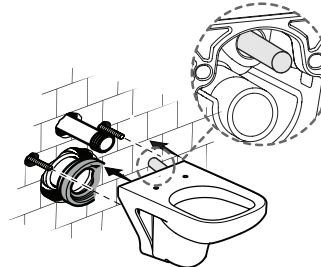

12. Level the toilet with Spirit level.

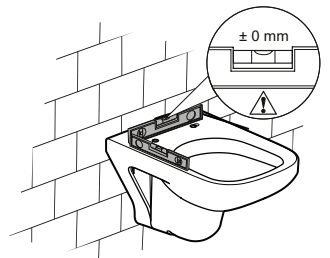

13. Insert rubber, washer & fixing nut for securing the toilet with the wall. Place the plastic caps.

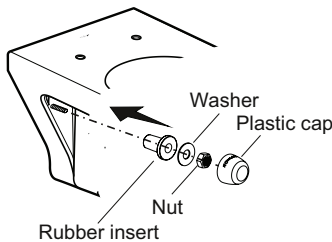

14. Flush the toilet. Check for leaks. Seal connections if required.

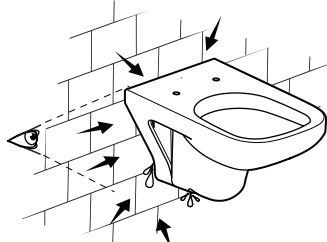

15. Seal around the edges. Do not use cement.

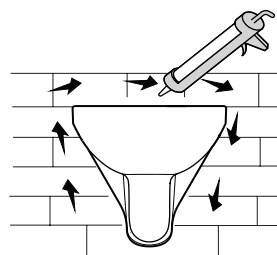

Recommended Installation Parts:

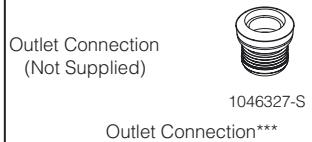
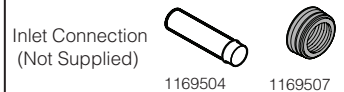

Recommended supports for Toilet installation :

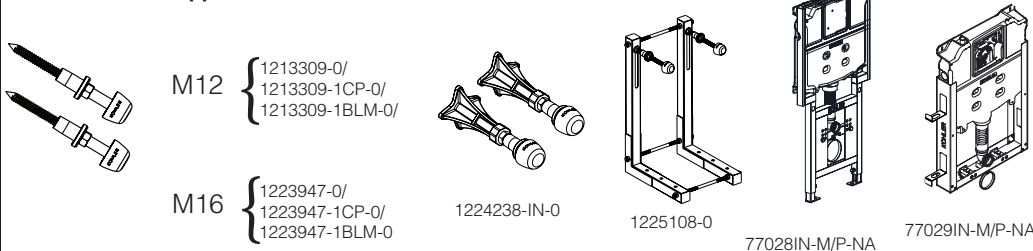

Spare part :

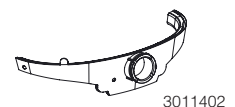

*** Installation parts shown aren't supplied with the product, to be procured separately

Note: Dimension A & B (as represented in pictures 6 to 10 above) to be adjusted as per specific site requirements.

Toll Free 1800 103 2244
 kohler.co.in
 © 2019 Kohler Co.